

SEA CLUB (Conference Center Details)

BALLROOM (GROUND FLOOR)

MEDITERRANEE ROOM (549m<sup>2</sup> | 5.909Ft<sup>2</sup>)

This room can be divided into 2:

- **Mediterranée East** (273.7 m<sup>2</sup> | 2946Ft<sup>2</sup>)
- **Mediterranée West** (273.7 m<sup>2</sup> | 2946Ft<sup>2</sup>)

The audiovisual equipment needs to be rented.

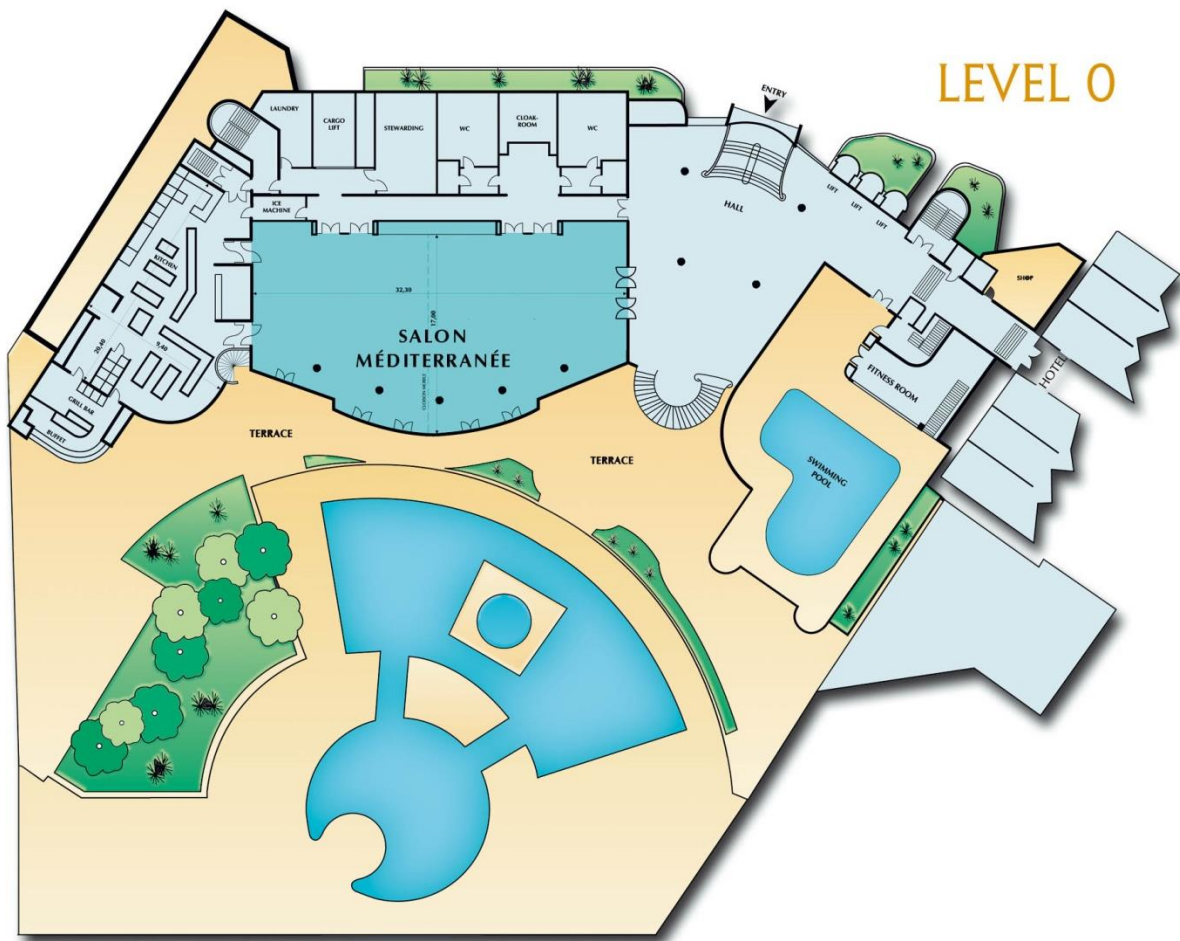

**BALLROOM (FLOOR 2)**

**ATLANTIQUE ROOM (579m<sup>2</sup> | 6.232Ft<sup>2</sup>)**

This room can be divided into 3:

- Atlantique East (158 m<sup>2</sup> | 1701Ft<sup>2</sup>)
- Atlantique Meridional (230 m<sup>2</sup> | 2476Ft<sup>2</sup>)
- Atlantique West (191 m<sup>2</sup> | 2056Ft<sup>2</sup>)

The room has an existing stage by Atlantique West. The audiovisual equipment needs to be rented.



**LEVEL 2**

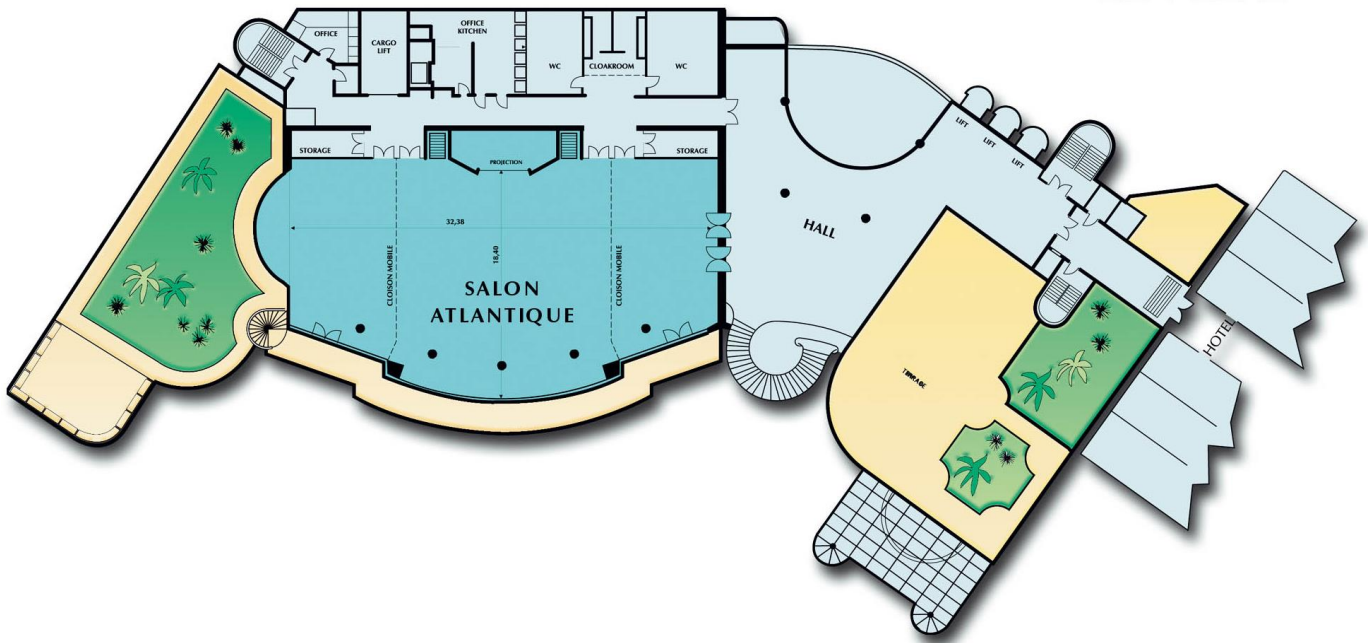

**TERRACE HALL 2**





**BREAKOUT ROOMS (FLOORS 1 & 4):**

All our breakout rooms have natural day light except for Alizée and Brevia, and most of them have large windows, private terrace and views of the sea.

They all have a build in screen. A video projector or any other AV equipment will need to be rented with a supplement.

The hotel has the following breakout rooms:

**FLOOR 1**

1. Arctique (17m<sup>2</sup> | 183Ft<sup>2</sup>) – Boardroom for 6 pax max
2. Adriatique (54.2m<sup>2</sup> | 583Ft<sup>2</sup>)
3. Baltique (18m<sup>2</sup> | 194Ft<sup>2</sup>) – Boardroom for 6 pax max
4. Egee (45m<sup>2</sup> | 484Ft<sup>2</sup>) – Fixed set up in boardroom for 14 pax
5. Pacifique (88m<sup>2</sup> | 947Ft<sup>2</sup>)

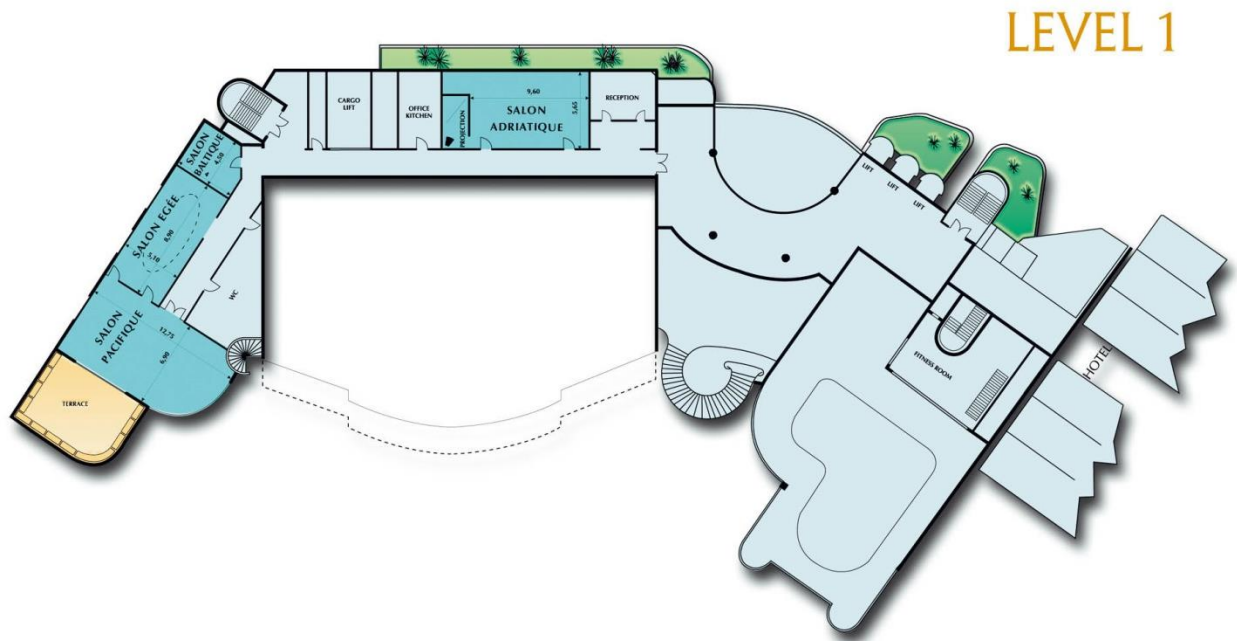

**LEVEL 1**



FLOOR 4

6. Mistral (35.4m<sup>2</sup> | 381Ft<sup>2</sup>)
7. Tramontane (26.4m<sup>2</sup> | 284Ft<sup>2</sup>)
8. Sirocco 1 (27.9 m<sup>2</sup> | 300Ft<sup>2</sup>)
9. Sirocco 2 (27.9 m<sup>2</sup> | 300Ft<sup>2</sup>) – Or Sirocco1+2 (55.9m<sup>2</sup> | 602Ft<sup>2</sup>)
10. Foehn (26.4m<sup>2</sup> | 284Ft<sup>2</sup>)
11. Zephyr (128.2m<sup>2</sup> | 1380Ft<sup>2</sup>)
12. Alizee 1 (30.2m<sup>2</sup> | 325Ft<sup>2</sup>) - No daylight.
13. Alizee 2 (30.2m<sup>2</sup> | 325Ft<sup>2</sup>) – Or Alizee 1+2 (68.7m<sup>2</sup> | 739Ft<sup>2</sup>) - No daylight.
14. Brevia (12.8m<sup>2</sup> | 137.8Ft<sup>2</sup>) – Boardroom for 8 pax max - No daylight, normally used as storage

LEVEL 4

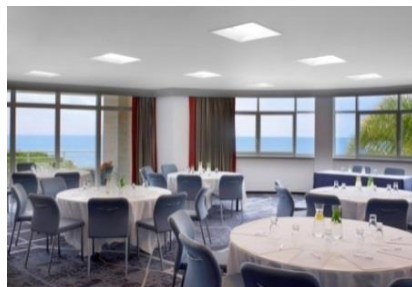
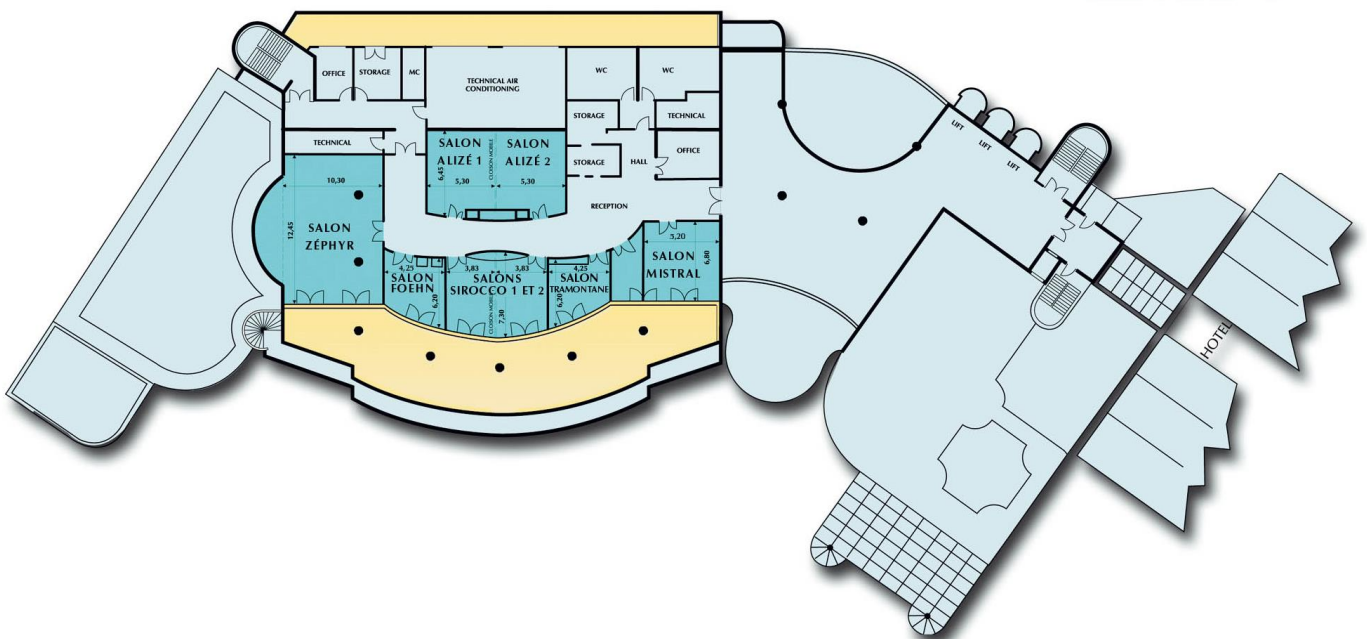

EXHIBITION / COFFEE BREAK AREAS

HALL 0



HALL 2

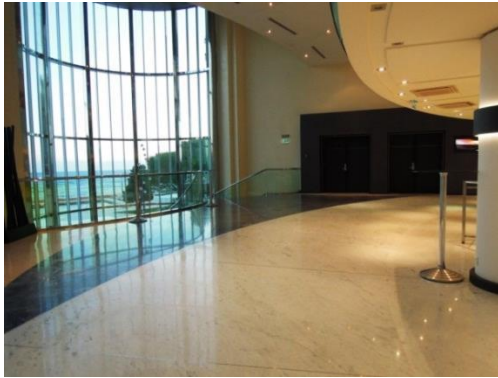

HALL 4





**DIFFERENT SPACES FOR YOUR OUTDOOR EVENING MEALS**

When using an outdoor area, a backup will be foreseen in case of bad weather.  
Rental/privatization fees will apply.

**MEDITERRANEE TERRACE**



**ROOFTOP TERRACE** (ideal for a cocktail or standing buffet dinner)



**BEACH** (ideal for a BBQ or informal buffet dinner)

*Available all year (from May to September, only in the evening)*



*The above furniture needs to be rented with a supplement*

POOL (ideal for a cocktail, buffet or sit down dinner)

*Available all year (from May to September, only in the evening)*





Ground floor

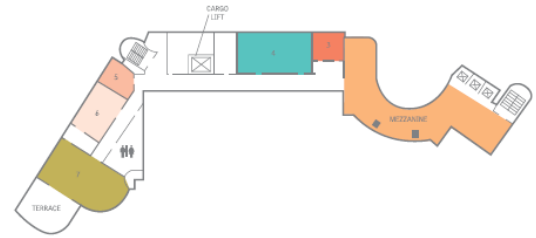

First floor



Second floor



Fourth floor



		Ft <sup>2</sup>	M <sup>2</sup>	FL (HxLxW)	M (HxLxW)	Theater	Classroom	U-shape	Cabaret	Boardroom	Cocktail	Banquet
Ground Floor	MEDITERRANEE E & W	5909	549	16.4x105x55.7	5x32.3x17	450	340	86	240	82	550	360
	MEDITERRANEE E or W	2946	273,7	16.4x52.8x55.7	5x16.1x17	200	130	45	112	40	220	168
	HALL 0	2475	230	X	X	X	X	X	X	X	120	X
	TERRASSE MED	4693	436	X	X	X	X	X	X	X	250	180
First Floor	ARCTIQUE	183	17	11.5x17.2x10.5	3.5x5.25x3.20	X	X	X	X	6	X	X
	ADRIATIQUE	583	54,2	8.2x31.5x18.5	2.5x9.6x5.65	50	36	32	32	32	60	X
	BALTIQUE	194	18	8.2x14.7x13.1	2.5x4.5x4	X	X	X	X	6	X	6
	EGEE	4887	45,4	8.2x29.2x16.7	2.5x8.9x5.1	X	X	X	X	14	X	X
	PACIFIQUE	947	88	8.2x41.6x22.6	2.5x12.7x6.9	70	50	30	32	36	80	X
	HALL 1	968	90	X	X	X	X	X	X	X	80	X
Second Floor	ATLANTIQUE E & M & W	6232	579	16.4x105x59	5x32x18	520	340	86	240	82	570	360
	ATLANTIQUE E	1701	158	16.4x47.9x34.7	5x14.6x10.6	140	80	32	72	34	150	108
	ATLANTIQUE M	2476	230	16.4x69.8x35.4	5x21.3x10.8	200	120	140	88	76	200	132
	ATLANTIQUE W	2056	191	16.4x52.4x39.4	5x16x12	180	110	32	80	34	170	120
	HALL 2	1938	180	X	X	X	X	X	X	X	180	X
	TERRASSE HALL 2	2045	190	X	X	X	X	X	X	X	150	110
Fourth Floor	MISTRAL	381	35,4	8.2x22.3x17	2.5x6.8x5.2	25	18	15	16	12	30	X
	TRAMONTANE	284	26,4	8.2x20.3x13.9	2.5x6.2x4.25	26	12	9	16	12	20	X
	SIROCCO 1 & 2	602	55,9	8.2x23x24	2.5x7x7.3	60	40	24	30	24	50	X
	SIROCCO 1 or 2	300	27,9	8.2x23x12.5	2.5x7x3.8	25	12	15	16	12	25	X
	FOEHN	284	26,4	8.2x20x13.9	2.5x6x4.25	20	12	9	16	12	20	X
	ZEPHYR	1380	128,2	8.2x40.6x33.8	2.5x12.4x10.3	80	55	32	48	34	70	X
	ALIZEE 1 & 2	739	68,7	8.2x37.4x17.4	2.5x11.4x5.3	60	36	28	32	28	50	X
	ALIZEE 1 or 2	325	30,21	8.2x18.7x17.4	2.5x5.70x5.3	25	15	15	16	16	25	X
	BREVA	137,8	12,8	8.2x10.5x13.1	2.5x3.2x4	X	X	X	X	8	X	8
	HALL 4	1938	180	X	X	X	X	X	X	X	120	X
	TERRASSE 5	12917	1200	X	X	X	X	X	X	X	200	X
INTEMPO BRASSERIE	3606	335	X	X	X	X	X	X	X	X	120	
TERRASSE INTEMPO	1938	180	X	X	X	X	X	X	X	250	130	
INTEMPO SALON	710	66	X	X	X	X	X	X	X	60	40	
TERRASSE SUPERIEURE	1292	120	X	X	X	X	X	X	X	X	70	
TERRASSE POOL BEACH	3337	310	98.4x21.6	30x6.60	X	X	X	X	X	300	X	
BEACH	9688	900	X	X	X	X	X	X	X	600	X	
POOL	5856	544	X	X	X	X	X	X	X	500	300	